

Honeywell

CT30 XP Series Universal Dock and Booted Accessories

User Guide

Disclaimer

Honeywell International Inc. (“HII”) reserves the right to make changes in specifications and other information contained in this document without prior notice, and the reader should in all cases consult HII to determine whether any such changes have been made. HII makes no representation or warranties regarding the information provided in this publication.

HII shall not be liable for technical or editorial errors or omissions contained herein; nor for incidental or consequential damages resulting from the furnishing, performance, or use of this material. HII disclaims all responsibility for the selection and use of software and/or hardware to achieve intended results.

This document contains proprietary information that is protected by copyright. All rights are reserved. No part of this document may be photocopied, reproduced, or translated into another language without the prior written consent of HII.

Copyright © 2022 Honeywell International Inc. All rights reserved.

Web Address: sps.honeywell.com

Trademarks

Other product names mentioned in this manual may be trademarks or registered trademarks of their respective companies and are the property of their respective owners.

Patents

For patent information, see www.hsmpats.com.

TABLE OF CONTENTS

Customer Support	v
Technical Assistance	v
Product Service and Repair	v
Limited Warranty	v
Chapter 1 - Introduction	1
List of Universal Dock and Booted Accessories	2
Agency Models	2
Chapter 2 - Protective Boot.....	3
Out of the Box	3
Attach the Protective Boot.....	3
Remove Protective Boot.....	4
Chapter 3 - Universal Dock Home Base and Ethernet Home Base	7
Features	7
Out of the Box	8
Connect Power	8
Charge the Battery Pack.....	9
Status LED	10
Mount the Home Base	10
Chapter 4 - Charge Base and Ethernet Base.....	11
Features	11

Out of the Box.....	12
Connect Power.....	12
Charge the Battery Pack	12
Mount the Charge Base or Net Base.....	13

Chapter 5 - Universal Dock 5-Bay Charge Base..... 15

Features.....	15
Out of the Box.....	16
Insert the Battery Charger.....	17
Connect Power.....	18
Charge the Battery Pack	18
Status LED.....	18

Chapter 6 - Universal Dock Display Dock..... 19

Features.....	19
Out of the Box.....	20
Dock Connectors.....	20
Connect Power	20
Connect to Monitor	20
Connect to an Ethernet Network.....	20
Connect to a USB Device.....	21
Status LED.....	21
Check Software on Computer.....	21
Insert Computer into the Dock.....	21
Configure the Display Dock Settings.....	22
Set Display Dock Settings.....	22
Set Monitor Settings	22
Set Peripheral Settings	23
Set Mode Settings.....	23
Connected Devices	23
Monitor Connections.....	23
USB Devices	24

Clean the Dock	24
Mount the Display Dock	24
Chapter 7 - Quad Battery Charger	27
Features	27
Out of the Box	28
Connect Power	28
Charge the Battery	28
Status LED	29
Mount the Quad Battery Charger	29
Chapter 8 - Universal Dock Cups	31
Out of the Box	31
Replacing a Universal Cup	32

Customer Support

Technical Assistance

Go to sps.honeywell.com, and then select **Support > Productivity** to find a host of options to help you quickly find the support you need and/or who to contact.

Product Service and Repair

Honeywell International Inc. provides service for all of its products through service centers throughout the world. Go to sps.honeywell.com, and then select **Support** to find a service center near you or to get a Return Material Authorization number (RMA #) before returning a product.

Limited Warranty

For warranty information, go to sps.honeywell.com and select **Support > Warranties**.

INTRODUCTION

Honeywell offers a full range of universal and boot-compatible accessories for the CT30 XP mobile computer, including:

- Protective Boots ([page 3](#))
- Home Bases and Ethernet Bases for one device and one battery ([page 7](#))
- Charge and Ethernet Bases for up to four devices ([page 11](#))
- 5-Bay Charge Bases with an optional battery charger ([page 15](#))
- Display Docks ([page 19](#))
- Quad Battery Chargers ([page 27](#))
- Replacement Cups for Universal Bases ([page 31](#))

Note: *Throughout this manual, all versions of the mobile device are referred to as the computer unless information is specific to a particular model.*



Caution: We recommend the use of Honeywell accessories and power adapters. Use of any non-Honeywell accessories or power adapters may cause damage not covered by the warranty.

Mise en garde : Il est recommandé d'utiliser les périphériques, les cordons d'alimentation et les adaptateurs secteur conçus par Honeywell. L'utilisation de tout périphérique, cordon d'alimentation ou adaptateur secteur d'une autre marque est susceptible de provoquer des dommages non couverts par la garantie.



Caution: Make sure that all components are dry prior to using the computers and batteries with accessories. Using wet components may cause damage not covered by the warranty.

Mise en garde : Assurez-vous que tous les composants sont secs avant de connecter les terminaux/batteries à des périphériques. L'insertion de composants humides risque de provoquer des dommages non couverts par la garantie.

List of Universal Dock and Booted Accessories

Note: For information on CT30 XP RFID Bracket options for your Honeywell RFID reader, refer to the RFID reader user guide. Product documentation is available for download at sps.honeywell.com.

Accessory	Part Number	Use With
Protective Boot	CT30P-PB-XP	CT30 XP
Universal Home Base	CT30P-HB-UVN	CT30 XP without boot
	CT30P-HB-UVB	CT30 XP with boot
Universal Ethernet Home Base	CT30P-EB-UVN	CT30 XP without boot
	CT30P-EB-UVB	CT30 XP with boot
Universal Charge Base	CT30P-CB-UVN	CT30 XP without boot
	CT30P-CB-UVB	CT30 XP with boot
Universal 5-Bay Charger	CT30-5CB-UVN	CT30 XP without boot
	CT30-5CB-UVB	CT30 XP with boot
Universal Ethernet (Net) Base	CT30P-NB-UVN	CT30 XP without boot
	CT30P-NB-UVB	CT30 XP with boot
Universal Display Dock	CT30P-DB-UVN	CT30 XP without boot
	CT30P-DB-UVB	CT30 XP with boot
Universal Cup	CT30P-UCP-N	CT30XP without boot
	CT30P-UCP-B	CT30XP with boot
Quad Battery Charger	CT30P-QBC	CT30P-BTSC battery pack

For a complete list of accessories for your mobile computer and their part numbers see the *Accessory Guide* for your device, available for download at sps.honeywell.com.

Contact your local sales representative for ordering information.

Agency Models

CT30P-HB, CT30P-EB, CT30P-CB, CT30-5CB, CT30P-NB, CT30P-DB

PROTECTIVE BOOT

Honeywell offers the following protective boots for use with a CT30 XP:

- CT30P-PB-XP

Honeywell also offers a series of boot-compatible communication and charge accessories that do not require you to remove the protective boot from the device before use.

To learn more, see [List of Universal Dock and Booted Accessories](#) on page 2.

Out of the Box

Make sure that your shipping box contains the following:

- Protective Boot (CT30P-PB-XP)

If any items are missing or appear damaged, contact your Customer Account Representative. Keep the original packaging in the event that you need to return the Vehicle Dock for service or if you want to store the charger while not in use.

Attach the Protective Boot

Note: *When used with a scan handle, the hand strap should be removed prior to installation.*

1. Insert the computer into the bottom of the boot.

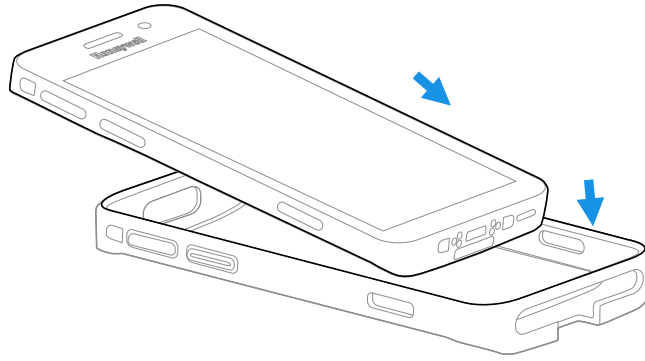

2. Press down evenly.

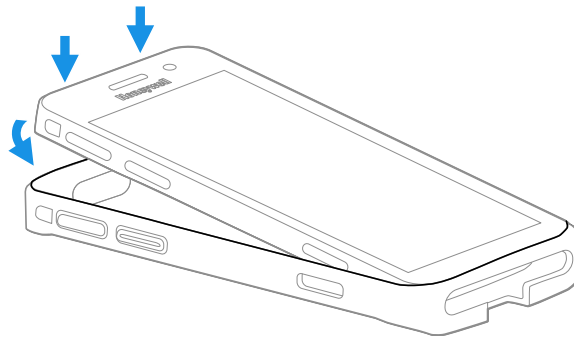

3. Verify the boot lip overlaps the front of the device.

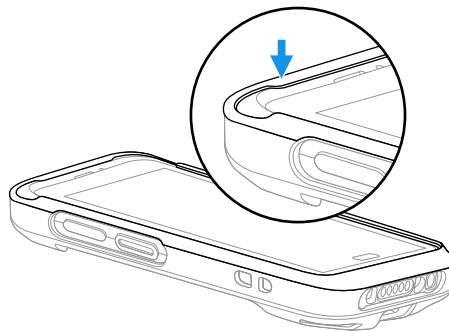

Remove Protective Boot

Note: *The protective boot does not need to be removed for battery replacement or charging with a compatible base (see page 2).*

Routinely inspect the protective boot for damage, and replace if needed. See [page 2](#) to determine the appropriate replacement boot for your computer.

1. Hold the unit on both sides with the screen facing toward you. Use your thumbs to apply even pressure to the upper lip of the boot.

2. Apply gentle pressure to the back of the unit to release the top of the unit from the boot.

1

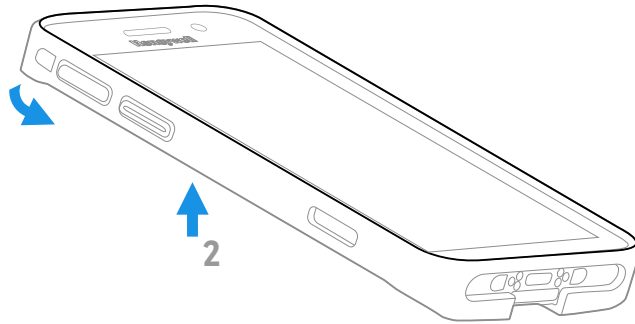

3. Lift the unit up and out of the bottom of the boot.

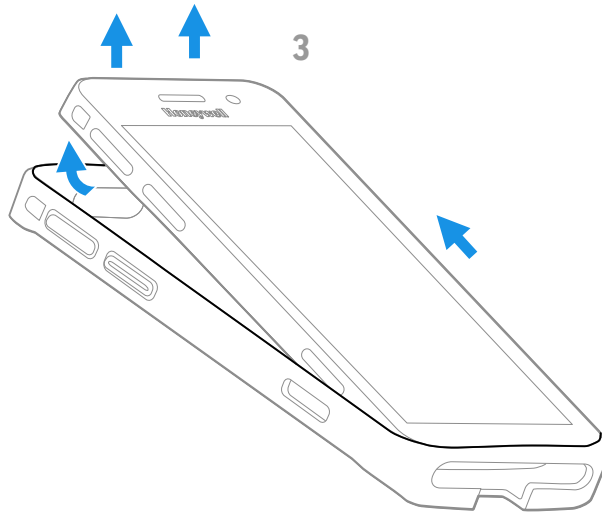

UNIVERSAL DOCK HOME BASE AND ETHERNET HOME BASE

A Home Base is a charge/communication base for one mobile computer and one spare battery. The Home Base has one USB client connector.

An Ethernet Home Base is also a charge/communication base for one mobile computer and one spare battery. However, the Ethernet Base also has an Ethernet connector as well as a USB client connector (Type B).

The CT30P-HB-UVB Universal Dock Home Base and CT30P-EB-UVB Universal Dock Ethernet Base are boot-compatible. The CT30P-HB-UVN Universal Home Base and CT30P-EB-UVN Universal Ethernet Base must be used with a computer without a boot attached. Universal bases have removable cups that can be replaced. (See [Universal Dock Cups](#) on page 31.)

Features

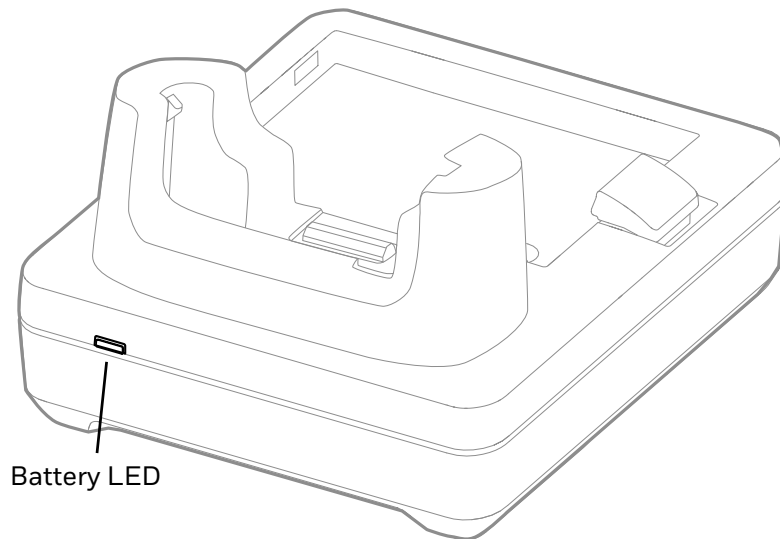

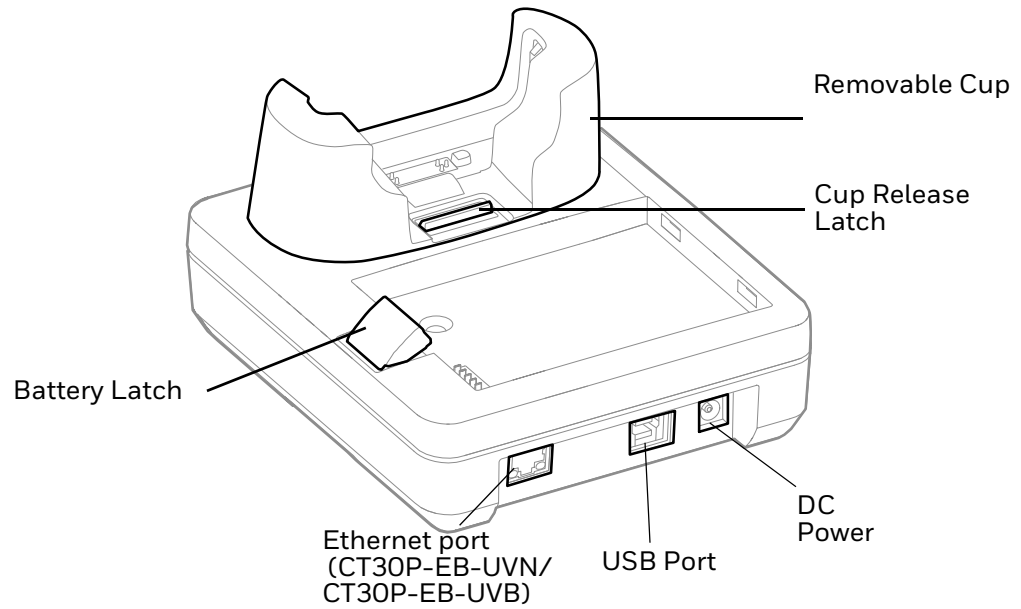

Out of the Box

Make sure that your shipping box contains these items:

- Home Base (CT30P-HB-UVN/CT30P-HB-UVB) or Ethernet Home Base (CT30P-EB-UVN/CT30P-EB-UVB)
- Power supply
- Power cord (if purchased)
- Product documentation

If any of these items are missing or appear damaged, contact your Customer Account Representative. Keep the original packaging in the event that you need to return the base for service or if you want to store the charger while not in use.

Connect Power

Use only a UL Listed power supply that has been qualified by Honeywell with an output rated at 12VDC and 3A. The power supply input rating is 90-264 VAC, 50/60 Hz. The operating temperature is -10 °C to 50 °C (14 °F to 122 °F). The maximum output of the base is 5VDC/2A.

1. Plug the power cord into the power supply.
2. Plug the power supply cable into the power connector on the back of the base.
3. Plug the power cord into a standard wall outlet.

Charge the Battery Pack

Insert computer into Home Base (CT30P-HB-UVN, CT30P-HB-UVB) or Ethernet Home Base (CT30P-EB-UVN, CT30P-EB-UVB). Unit will not charge unless a battery is installed.

CT30P-HB-UVN/CT30P-EB-UVN

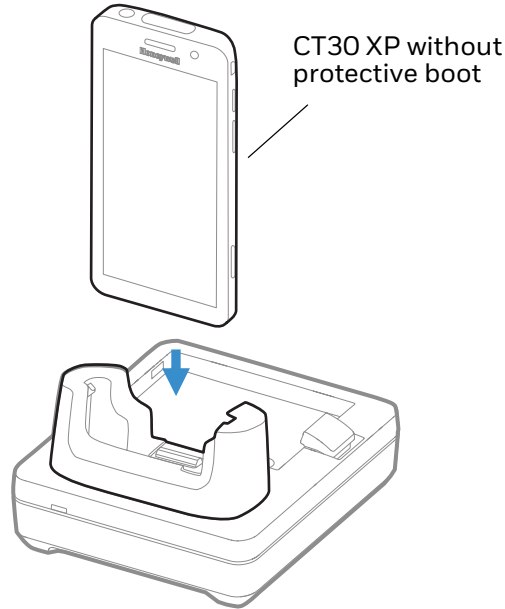

CT30P-HB-UVB/CT30P-EB-UVB

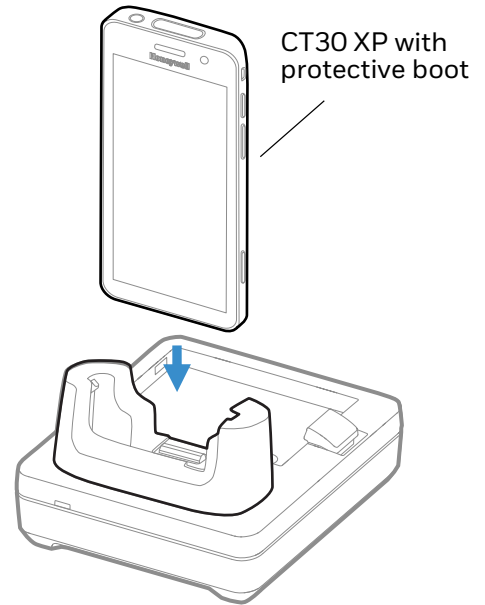

You can also insert a battery pack into the Home Base for charging.

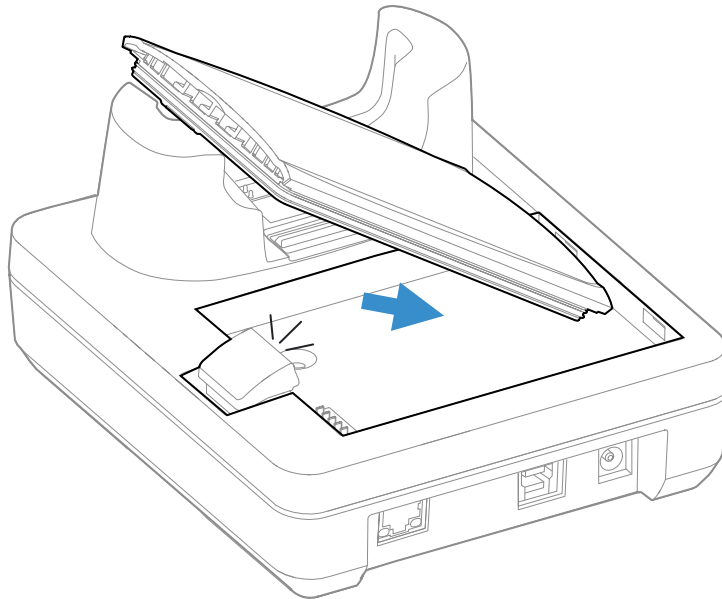

Status LED

LED	Status	Description
Battery	Solid Green	The battery is connected to external power and is fully charged.
	Solid Amber	The battery is connected to external power and is charging.
	Flashing Red	There is a battery charging fault, such as over-temperature.

Mount the Home Base

You can mount the Home Base on a flat, horizontal surface such as a desktop or workbench with an optional DIN rail.

Mounting hardware required:

- DIN rail
- 3/16-inch diameter x 5/8-inch long pan head screw
- 1/2-inch OD x 7/32-inch ID x 3/64-inch thick washer
- 3/16-inch diameter nut

1. Slide the DIN rail into the slot on the bottom of the Home Base.
2. Secure the DIN rail to the flat surface with the hardware.

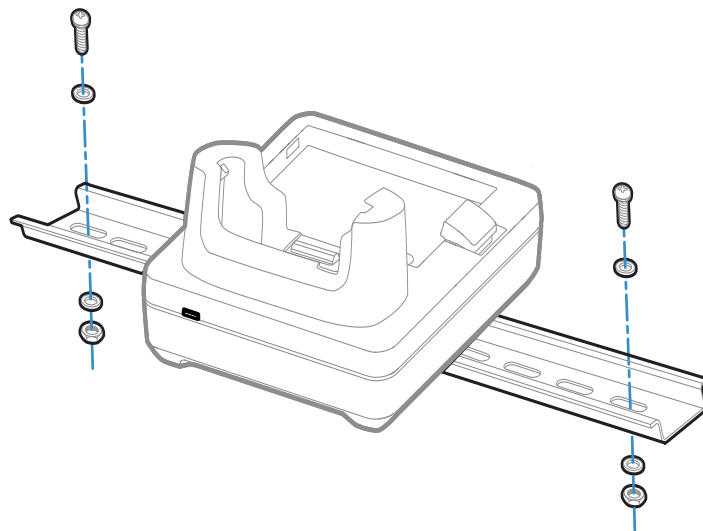

CHARGE BASE AND ETHERNET BASE

Universal Dock Charge Bases CT30P-CB-UVN and CT30P-CB-UVB charge up to four mobile computers. Model CT30P-CB-UVB is boot compatible.

Ethernet (Net) Bases CT30P-NB-UVN and CT30P-NB-UVB hold four mobile computers and function as both charge and communication bases, with two RJ45 Ethernet ports. Model CT30P-NB-UVB is boot compatible.

Universal bases CT30P-CB-UVN, CT30P-CB-UVB, CT30P-NB-UVN, and CT30P-NB-UVB have removable cups that can be replaced. (See [Universal Dock Cups](#) on page 31.)

Features

CT30P-CB-UVN/CT30P-CB-UVB/CT30P-NB-UVN/CT30P-NB-UVB

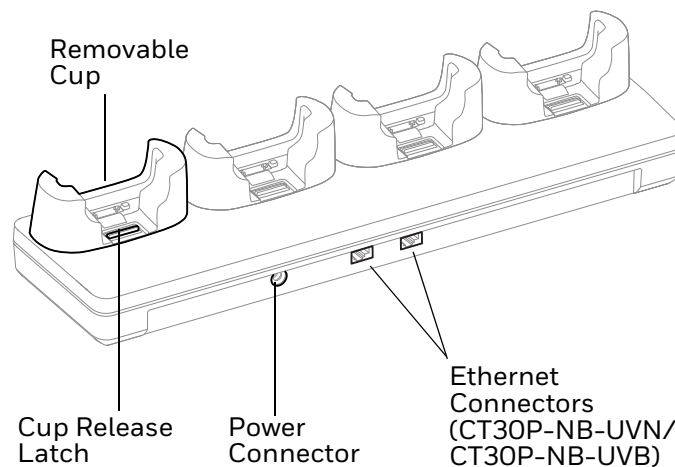

Out of the Box

Make sure that your shipping box contains these items:

- Charge Base (CT30P-CB-UVN, CT30P-CB-UVB) or Ethernet Base (CT30P-EB-UVN, CT30P-NB-UVB)
- Power supply
- Power cord (if purchased)
- Product documentation

If any of these items are missing or appear damaged, contact your Customer Account Representative. Keep the original packaging in the event that you need to return the base for service or if you want to store the charger while not in use.

Connect Power

Use only a UL Listed power supply that has been qualified by Honeywell with an output rated at 12V/7A. The power supply input rating is 100-240 VAC, 50/60 Hz. The operating temperature is -10 °C to 50 °C (14 °F to 122 °F).

1. Plug the power cord into the power supply.
2. Plug the power supply cable into the power connector on the back of the base.
3. Plug the power cord into a standard wall outlet.

Charge the Battery Pack

Insert device with battery installed into the Charge Base or Net Base.

CT30P-CB-UVN/CT30P-NB-UVN

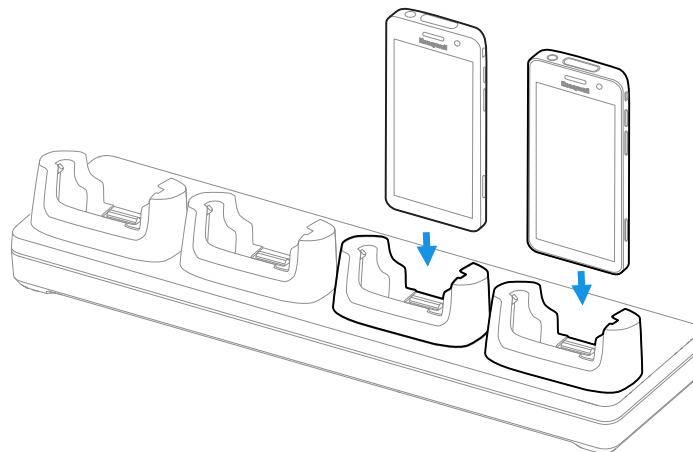

Mount the Charge Base or Net Base

You can mount the charger on a flat, horizontal surface such as a desktop or workbench with an optional DIN rail.

Mounting hardware required:

- DIN rail
 - 3/16-inch diameter x 5/8-inch long pan head screw
 - 1/2-inch OD x 7/32-inch ID x 3/64-inch thick washer
 - 3/16-inch diameter nut
1. Slide the DIN rail into the slot on the bottom of the Charge Base or Net Base.
 2. Secure the DIN rail to the flat surface with the hardware.

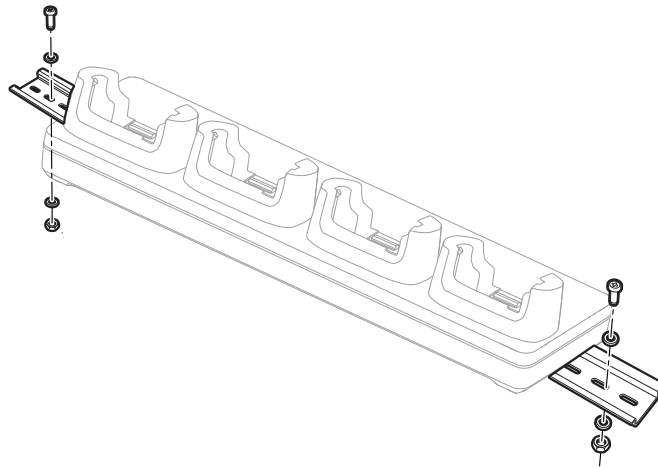

UNIVERSAL DOCK 5-BAY CHARGE BASE

The Universal Dock Five-Bay Charge Base provides the flexibility of charging five units, or four units and four batteries with the battery charger.

The CT30-5CB-UVB is boot-compatible. The CT30-5CB-UVN must be used with a computer that does not have a boot installed. Universal bases have removable cups that can be replaced. (See [Universal Dock Cups](#) on page 31.)

Features

CT30-5CB-UVN/CT30-5CB-UVB

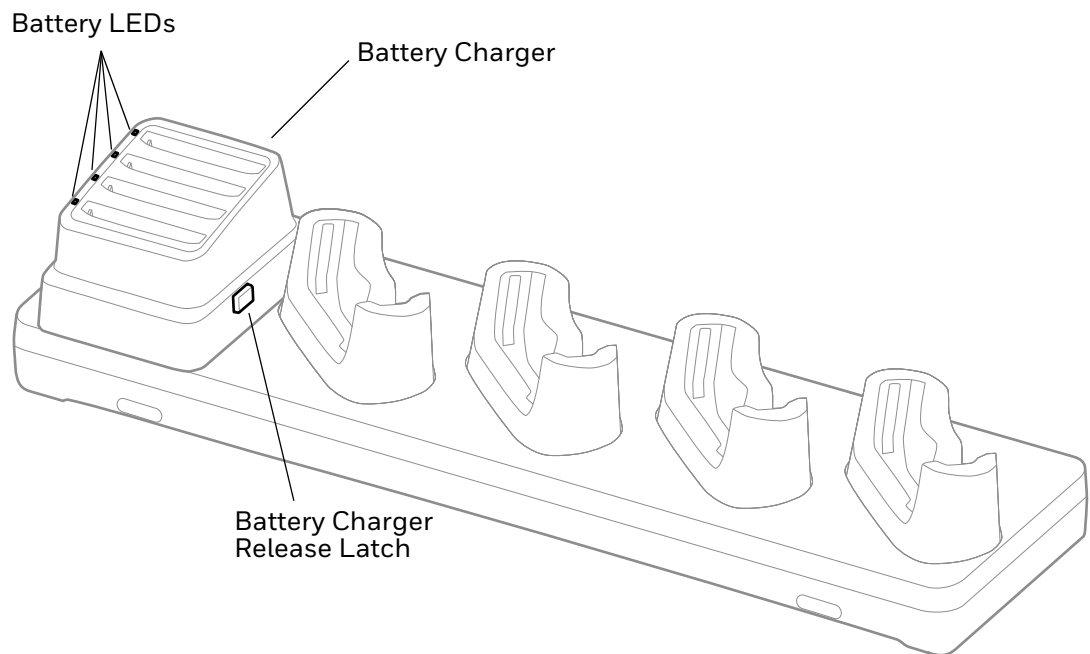

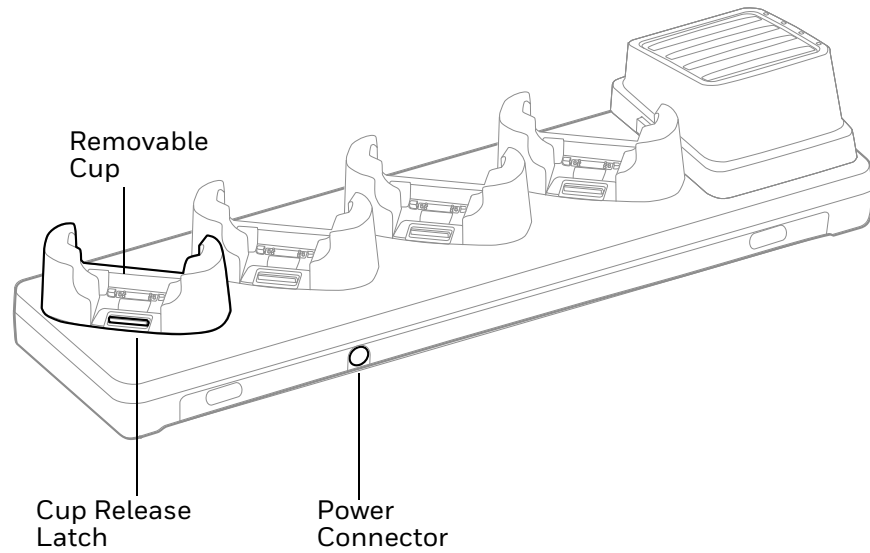

Out of the Box

Make sure that your shipping box contains these items:

- 5-Bay Charge Base (CT30-5CB-UVN/CT30-5CB-UVB)
- Power supply
- Power cord (if purchased)
- Product documentation

If any of these items are missing or appear damaged, contact your Customer Account Representative. Keep the original packaging in the event that you need to return the base for service or if you want to store the charger while not in use.

Insert the Battery Charger

Note: The Battery Charger must be installed in the location shown below.

1. Insert the battery charger tilted slightly to the left of the base.

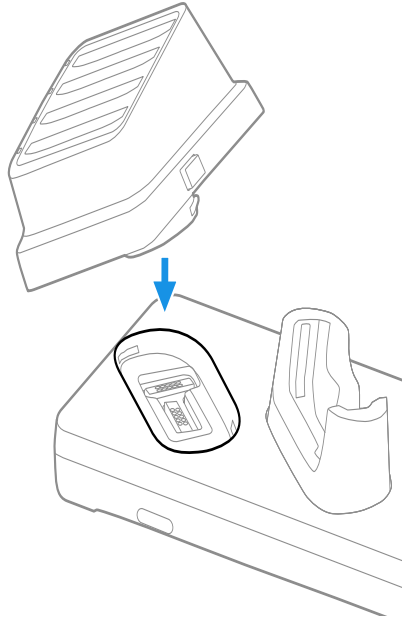

2. Press the latch release button as you push the battery charger down until it snaps in.

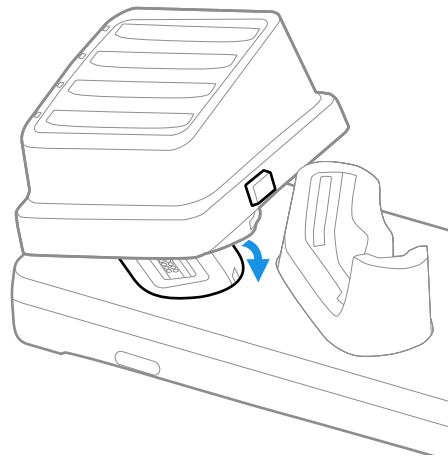

Connect Power

Use only a UL Listed power supply that has been qualified by Honeywell with an output rated at 12V/8A. The power supply input rating is 100-240 VAC, 50/60 Hz. The operating temperature is 0 °C to 45 °C (32 °F to 113 °F).

1. Plug the power cord into the power supply.
2. Plug the power supply cable into the power connector on the back of the base.
3. Plug the power cord into a standard wall outlet.

Charge the Battery Pack

Insert device with battery installed into the 5-Bay Charge Base. Or insert battery into the optional battery charger.

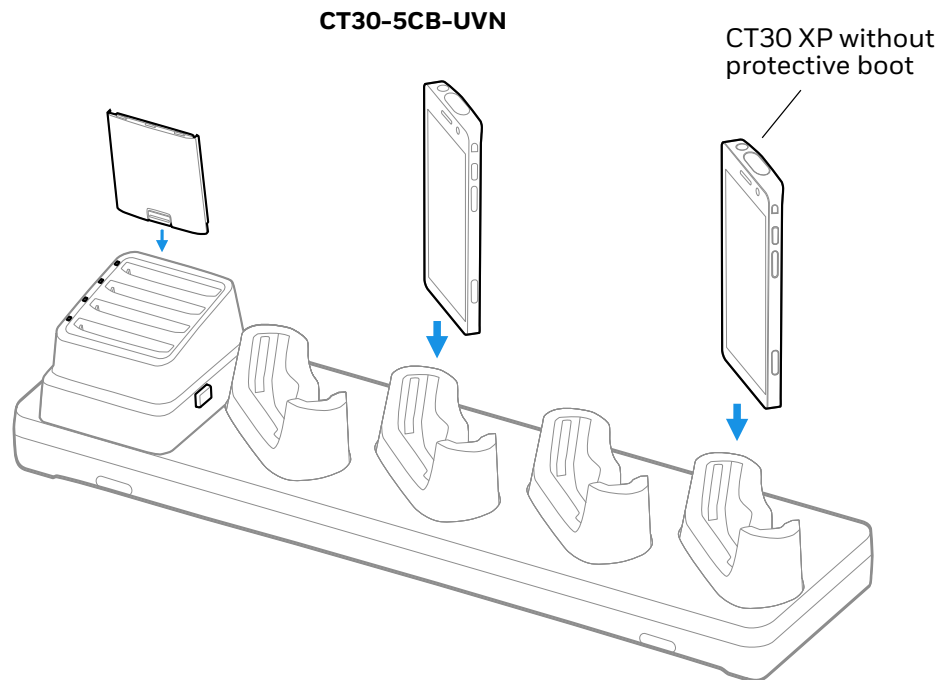

Status LED

LED	Status	Description
Battery	Solid Green	The battery is connected to external power and is fully charged.
	Solid Amber	The battery is connected to external power and is charging.
	Flashing Red	There is a battery charging fault, such as over-temperature.

UNIVERSAL DOCK DISPLAY DOCK

A display dock allows a CT30 XP to become a personal computer. A monitor, keyboard, mouse, and audio can be connected through the dock via the USB ports. The dock also provides an Ethernet connection.

The CT30P-DB-UVN accepts only a computer without a protective boot, while the CT30P-DB-UVB is compatible with a booted computer. Both universal display docks have removable cups that can be replaced. (See [Universal Dock Cups](#) on page 31.)

Features

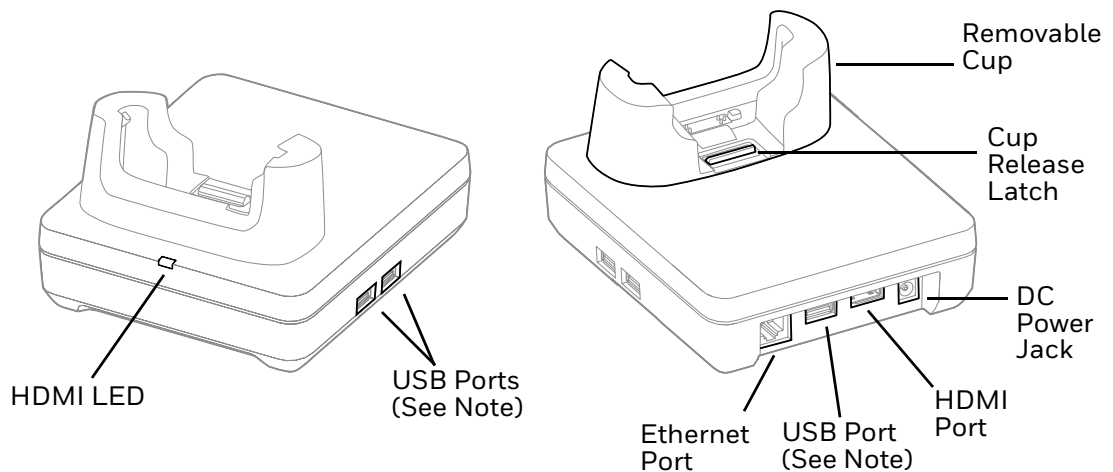

Note: The display dock supports USB direct connections only. The dock does not support USB hub connections, including keyboards with USB port(s).

Out of the Box

Make sure that your shipping box contains these items:

- CT30 XP Universal Display Dock (CT30P-DB-UVN or CT30P-DB-UVB)
- Power adapter
- Power cord
- Regulatory Sheet

If any of these items are missing or appear damaged, contact your Customer Account Representative. Keep the original packaging in the event that you need to return the base for service or if you want to store the charger while not in use.

Dock Connectors

Connect Power

Use only a UL Listed power supply that has been qualified by Honeywell with an output rated at 12 VDC and 3 A. The power supply input rating is 100-240 VAC, 50/60 Hz. The operating temperature is -10°C to 50°C (14°F to 122°F). The maximum output of the base is 5VDC/2A.

1. Plug the power cord into the power supply.
2. Plug the power supply cable into the power jack on the back of the dock.
3. Plug the power cord into a standard wall outlet.

Connect to Monitor

Note: See [Monitor Connections](#) on page 23 for a list of approved connections.

1. Plug the HDMI cable into the dock.
2. Plug the other end of the HDMI cable into the monitor.

Connect to an Ethernet Network

1. Plug the Ethernet cable into the dock.
2. Place the computer in the dock.

Note: For advanced Ethernet settings, go to sps.honeywell.com for the CT30 XP User Guide.

Connect to a USB Device

Note: See [USB Devices](#) on page 24 for a list of approved USB devices.

Note: The dock supports USB direct connections only. The dock does not support USB hub connections, including keyboards with USB port(s).

Plug the USB type A cable into a USB port on the dock.

Status LED

Status	Description
Constant Green	The dock is connected through HDMI.
Off	The dock is not connected or lost connection through HDMI.

Check Software on Computer

Computers powered by Android 8 or higher have the DisplayLink software installed by Honeywell.

Insert Computer into the Dock

Ensure the CT30 XP is fully seated into the dock.

CT30P-DB-UVN

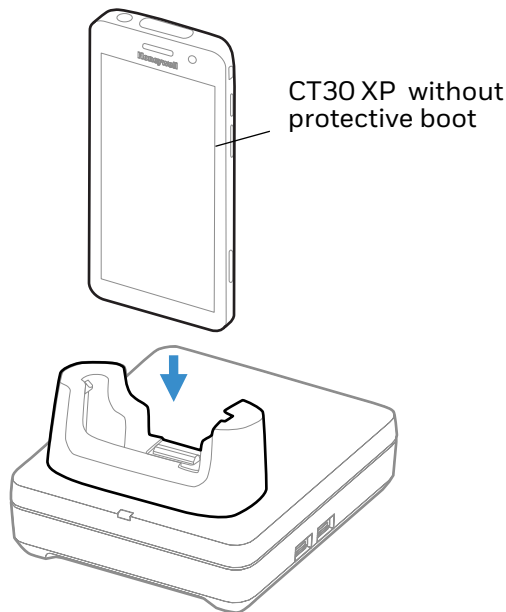

CT30P-DB-UVB

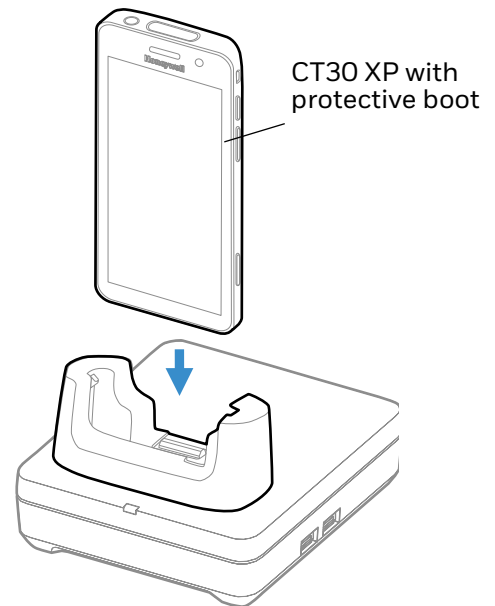

The first time you insert the computer into the dock, prompts appear on the screen. Follow the prompts on the screen to:

- Set default for DisplayLink Presenter to open when the USB device is connected.
- Start capturing everything that is displayed on your screen.

Note: *These prompts no longer appear when you insert the CT30 XP into the dock unless you left “Don’t show again” unchecked.*

The computer will automatically change to landscape and the resolution will update to the monitor settings.

Configure the Display Dock Settings

You can configure the parameters on the computer for the Display Dock using the Display Dock Settings app.

Set Display Dock Settings

The Display Dock Settings app is available from the all apps menu under Settings.

1. Swipe up from the bottom of the Home screen to access all apps.
2. Tap **Settings** > **Honeywell Settings** > **Display Dock Setting**.

Set Monitor Settings

1. Swipe up from the bottom of the Home screen to access all apps.
2. Tap **Settings** > **Honeywell Settings** > **Display Dock Setting**.
3. Choose one of the following options to set the view:
 - Tap **System portrait screen**, to have the computer stay in portrait view.
 - Tap **System landscape screen**, to have the computer stay in landscape view.
4. To set the system resolution, tap **Resolution** and choose one of the following options:
 - **1080 x 1920**
 - **720 x 1280**
5. To set the density, tap **Density** and chose one of the following options:
 - **160**
 - **240**
 - **320**
 - **400**

Set Peripheral Settings

1. Swipe up from the bottom of the Home screen to access all apps.
2. Tap **Settings** > **Honeywell Settings** > **Display Dock Setting**.
3. To set the right mouse button to the back key, tap **Right mouse button** to toggle the feature on or off.
4. Tap **HDMI audio** to toggle between **Sound to terminal** or **Sound to external monitor**.

Set Mode Settings

1. Swipe up from the bottom of the Home screen to access all apps.
2. Tap **Settings** > **Honeywell Settings** > **Display Dock Setting**.
3. To set the external monitor mode:
 - Select **Primary Mode** to automatically adjust as configured in settings or
 - Select **Mirror mode** to match the terminals settings.

Connected Devices

Monitor Connections

Supported Devices

- HDMI versions 1.4 and above
- VGA - supported through HDMI/VGA converter
- DVI - supported through HDMI/DVI converter

Non-Supported Devices

- HDMI splitter for two monitors
- Display Port

USB Devices

Supported Devices

- Standard three button mouse with scroll
- Standard QWERTY keyboard without HUB/USB type A ports on the keyboard
- USB headset/USB to 3.5mm audio converter
- USB mass storage devices (thumb drives), not recommended for large transfers (over 1GB)

Non-Supported Devices

- USB Hubs
- USB devices with additional USB type A ports

Clean the Dock

You may need to clean the dock to keep the dock in good working order. Clean the dock as often as needed for the environment in which you are using the dock with a dry soft cloth.

Mount the Display Dock

You can mount the dock on a flat, horizontal surface such as a desktop or workbench with an optional DIN rail.

Mounting hardware required:

- DIN rail
 - 3/16-inch diameter x 5/8-inch long pan head screw
 - 1/2-inch OD x 7/32-inch ID x 3/64-inch thick washer
 - 3/16-inch diameter nut
1. Slide the DIN rail into the slot on the bottom of the dock.
 2. Secure the DIN rail to the flat surface with the hardware.

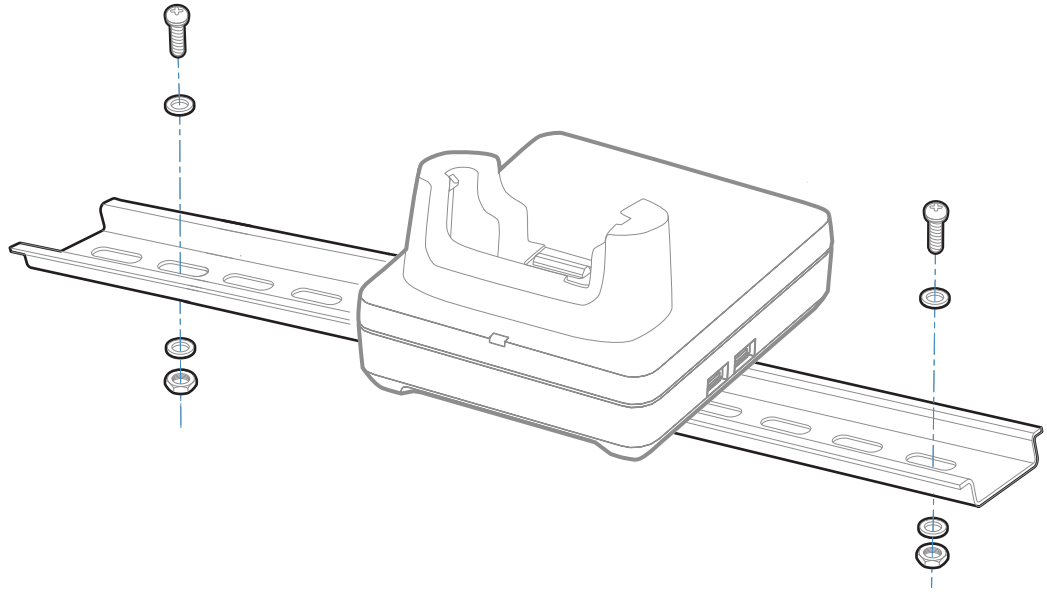

QUAD BATTERY CHARGER

The Quad Battery Charger allows for charging up to four CT30 XP batteries. The CT30P-QBC Quad Battery Charger uses the CT30P-QBC-UCP Battery Universal Dock Cup, which can be replaced and is also compatible with the [Universal Dock 5-Bay Charge Base](#).

Features

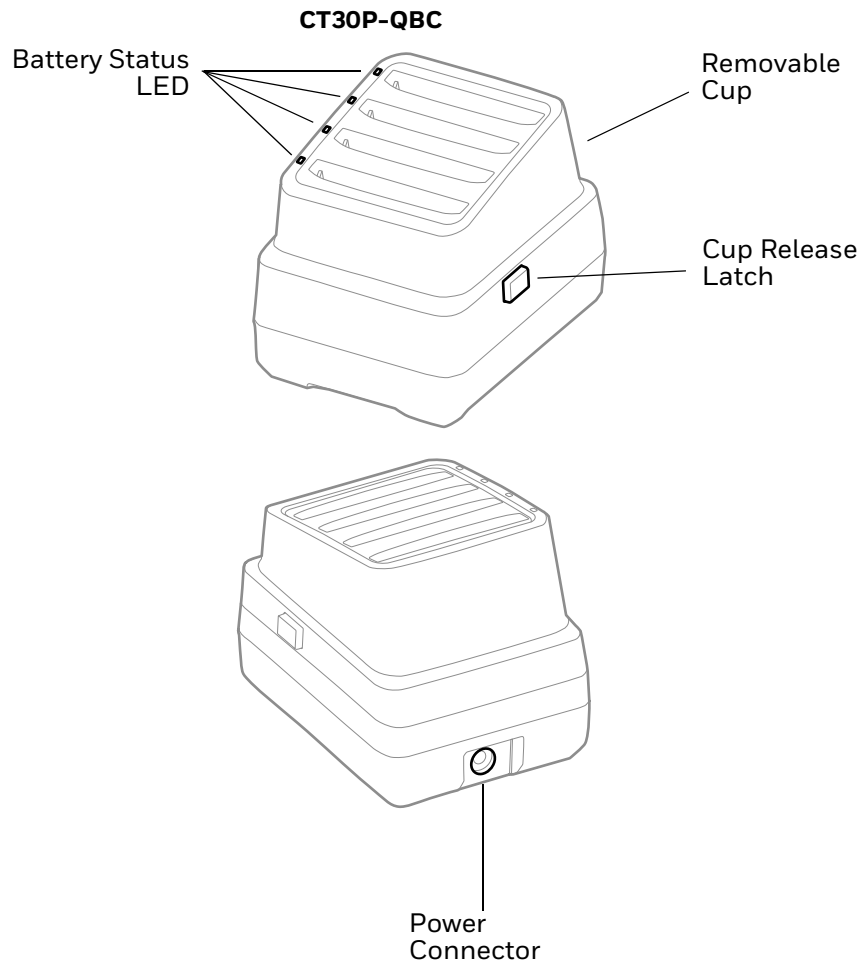

Out of the Box

Make sure that your shipping box contains these items:

- Quad Battery Charger (CT30P-QBC)
- Power supply
- Power cord (model dependent)
- Product documentation

If any of these items are missing or appear damaged, contact your Customer Account Representative. Keep the original packaging in the event that you need to return the base for service or if you want to store the charger while not in use.

Connect Power

Use only a UL Listed power supply that has been qualified by Honeywell with an output rated at 12V/8A. The power supply input rating is 100-240 VAC, 50/60 Hz. The operating temperature is 0 °C to 45 °C (32 °F to 113 °F).

1. Plug the power cord into the power supply.
2. Plug the power supply cable into the power connector on the back of the base.
3. Plug the power cord into a standard wall outlet.

Charge the Battery

Insert one to four battery packs into the charger.

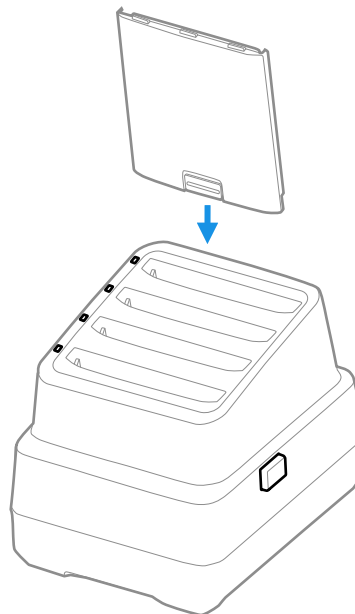

Status LED

LED	Status	Description
Battery	Solid Green	The battery is connected to external power and is fully charged.
	Solid Amber	The battery is connected to external power and is charging.
	Flashing Red	There is a battery charging fault, such as over-temperature.

Mount the Quad Battery Charger

You can mount the charger on a flat, horizontal surface such as a desktop or workbench with an optional DIN rail.

Mounting hardware required:

- DIN rail
 - 3/16-inch diameter x 5/8-inch long pan head screw
 - 1/2-inch OD x 7/32-inch ID x 3/64-inch thick washer
 - 3/16-inch diameter nut
1. Slide the DIN rail into the slot on the bottom of the charger.
 2. Secure the DIN rail to the flat surface with the hardware.

UNIVERSAL DOCK CUPS

Universal Bases have removable cups that can be replaced with Universal Cups CT30P-UCP-N and CT30P-UCP-B.

CT30P-UCP-N is for use with a CT30 XP computer without a boot. CT30P-UCP-B must be used with a CT30 XP computer with a boot attached.

For more information about the universal docks for CT30 XP computers, see:

- [Universal Dock Home Base and Ethernet Home Base](#) (page 7)
- [Charge Base and Ethernet Base](#) (page 11)
- [Universal Dock 5-Bay Charge Base](#) (page 15)
- [Universal Dock Display Dock](#) (page 19)

Out of the Box

Make sure that your shipping box contains these items:

- Universal Cup (CT30P-UCP-N or CT30P-UCP-B)

If any of these items are missing or appear damaged, contact your Customer Account Representative. Keep the original packaging in the event that you need to return the base for service or if you want to store the charger while not in use.

Replacing a Universal Cup

Note: The Universal Charge base is shown in the instructions below for illustration purposes. The steps for removing and inserting a cup are the same for all universal bases.

1. Push the latch towards the front of the base.

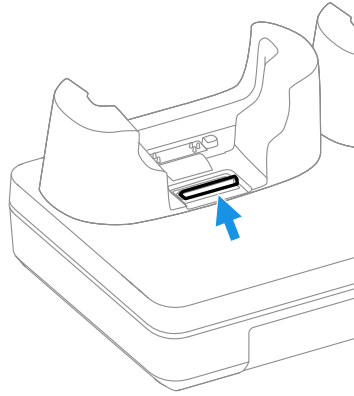

2. Tilt the back of the cup upwards.

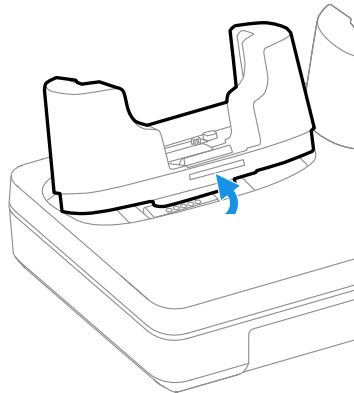

3. Lift the old cup out of the base.

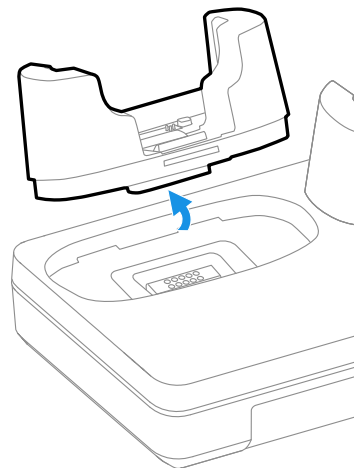

4. Insert the new cup tilted slightly towards the front of the base.

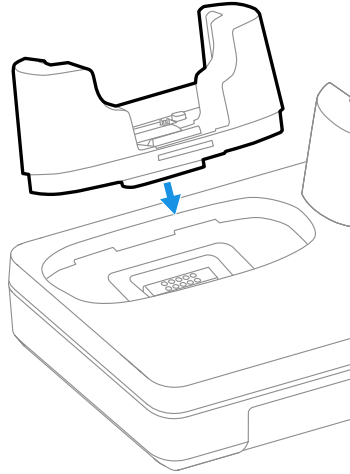

5. Push the cup into the base until it snaps in.

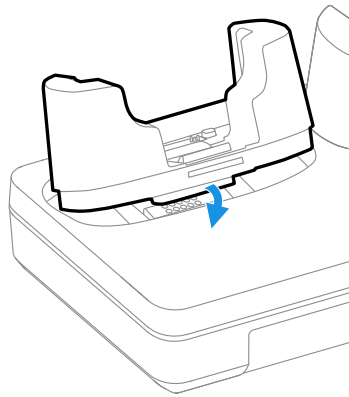

Honeywell
855 S. Mint Street
Charlotte, NC 28202

sps.honeywell.com